

Contents:

Lock Assembly
Striker Plate
Alcohol Wipe
Instructions
Warranty Card

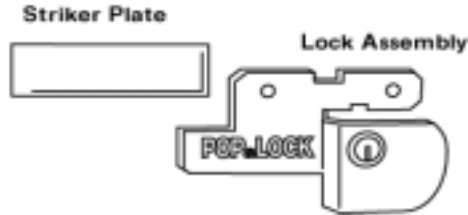

Tools Required:

Torx T-30 Driver
10 MM Socket

Tech Support:

Call 1-800-342-5911

For the latest instructions please visit www.popandlock.net

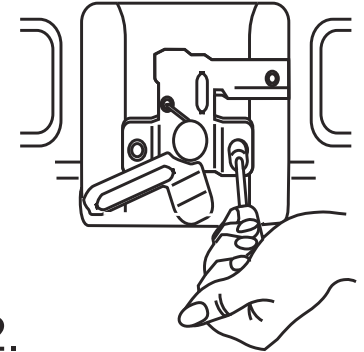

1.

Open the tailgate and remove the access panel inside the tailgate using the Torx T-30 Driver.

Note: Bedliner panel may have to be removed.

2.

Unscrew the two nuts using a 10MM wrench holding the handle assembly. DO NOT CLOSE TAILGATE FROM THIS POINT ON.

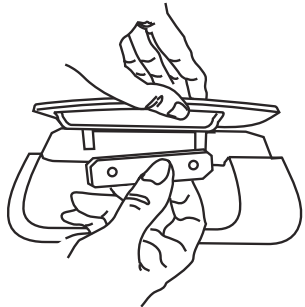

3.

Lift the handle assembly out and remove the mounting bracket located under the handle.

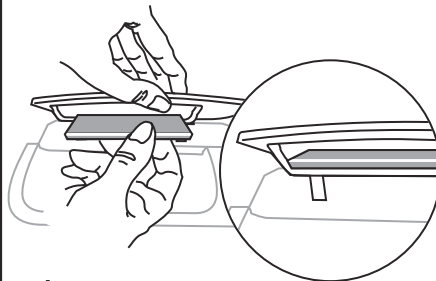

4.

Clean the inside of the handle with the alcohol wipe and attach the striker plate to the interior rear wall with the double-sided tape as shown.

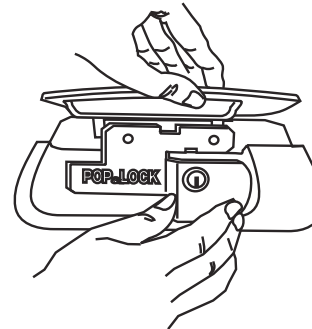

5.

Insert the Pop&Lock assembly in place of the mounting bracket.

6.

Re-install...and tighten the two nuts using a 10MM wrench. Close the tailgate and test the Pop&Lock.

Re-install the access panel.

LIMITED WARRANTY TERMS AND CONDITIONS

- (1) Installation Pop & Lock™, LLC (and Pop & Lock™ Corporation) is not responsible for installing the Pop & Lock™ or for the harm suffered by any person as a result installing it.
- (2) Warranties
- Customer acknowledges that it is unreasonable to believe that any device whatever will prevent a theft in the case of every attempt and that the most that can be expected from a so-called anti-theft or security device is that it will deter many thieves.
 - POP & LOCK™ LLC. (and Pop & Lock™ Corporation) MAKES, AND CUSTOMER RECEIVES, NO WARRANTY, EXPRESSED OR IMPLIED, EXCEPT THE WARRANTIES OF TITLE TO THE POP & LOCK™ AND THEIR MERCHANTABILITY, PARTICULARLY NO WARRANTY OF FITNESS FOR A PARTICULAR USE OR PURPOSE OR AGAINST INFRINGEMENT.**
 - As Customer's only remedy, Pop & Lock™, LLC (and Pop & Lock™ Corporation) will repair or replace, at its option and without charge, any lock that is defective in material or workmanship when received by Customer and is returned to Pop & Lock™ LLC (and Pop & Lock™ Corporation), FOB Pop & Lock™ Corporation's offices, within one (1) year after it's receipt by the Customer. Pop & Lock LLC will ship all replacement, or repaired, Locks to Customer, FOB Pop & Lock™'s shipping point.
 - Factory support is only available for Pop & Lock™ products purchased as **new** through an Authorized Pop & Lock™ dealer.
Please Note: Pop & Lock™ Products purchased on auction sites such as Ebay, Amazon and Craigslist, to name a few, will not be covered under factory warranty under any circumstance. Pop & Lock™, LLC (and Pop & Lock™ Corporation) is unable to verify whether products sold through Auction Sites are new, used, or refurbished, and as such, Pop & Lock, LLC (and Pop & Lock™ Corporation) is unable to warranty such purchases. Pop & Lock, LLC advises using extreme caution when buying through auction sites as you'll be doing so at your own risk.
- (3) No Liability Pop & Lock™ Corporation is not liable for any loss or damage claimed by Customer or any third person to have been suffered or incurred as a result or, or related to, the Locks purchased under this Agreement, regardless of the circumstances or form of action, except any bodily injury or death for which Pop & Lock™ is liable under products-liability law. Without limiting the generality of the foregoing, in no event will Pop & Lock™ LLC be liable to Customer for any indirect, special, or consequential damages, regardless of the circumstances or the cause of action, particularly not for the value of a vehicle, or any other money damages in the event that a tailgate is stolen either notwithstanding the use of a Pop & Lock™ or when it has been returned for repair or replacement.

END OF TERMS AND CONDITIONS

Please Mail Completed Warranty Form (below) In Self Addressed Envelope To:

POP & LOCK LLC 271 CONTRACT DRIVE GREEN BAY, WI USA 54304

Additional Install Instructions and answers to technical questions can be found on our website at www.popnlock.net or by calling

Technical Support 1-800-342-5911

Monday – Friday 8am to 5pm CST



POP & LOCK™ LIMITED WARRANTY FORM

Please complete and mail this form to record your warranty with the manufacturer.

NAME _____

POP & LOCK™ MODEL _____

ADDRESS _____

VEHICLE YEAR _____

CITY _____

VEHICLE MAKE/MODEL _____

STATE _____ ZIP _____

REASON FOR RETURN (Continue on other side):

TELEPHONE # _____

EMAIL ADDRESS _____